

Société de Promotion Immobilière Pour la Vente et la Location
PROJET DE CONSTRUCTION D'UN CENTRE DE VIE - MGHIRA III

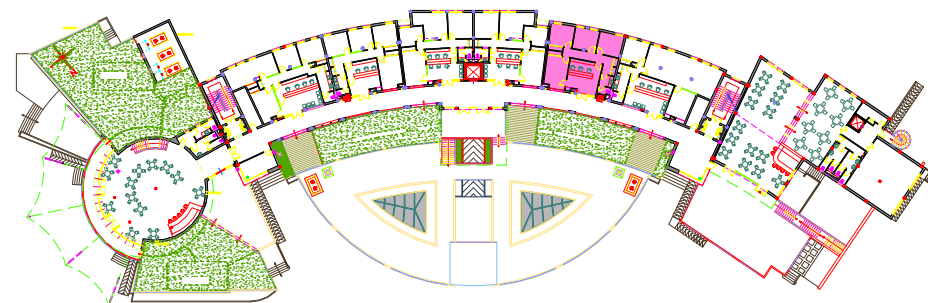
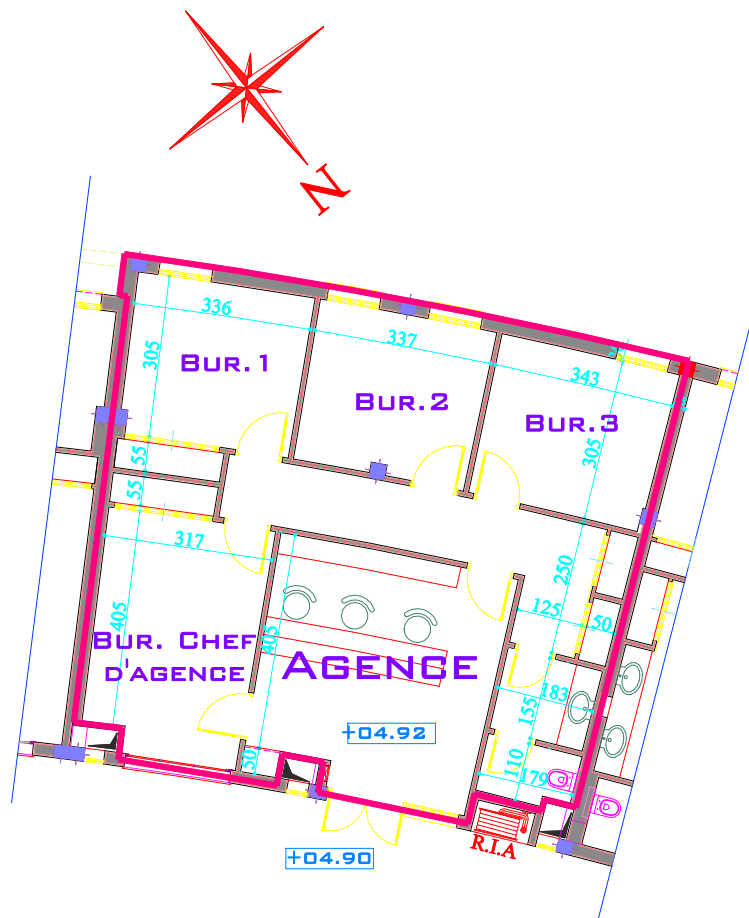

AGENCE 4

Niveau:	1er Etage
Surface Utile:	83,80 m ²
Surf H.D. :	92,67 m ²
Surface Commune:	30,50 m ²
Surf Vendable:	123,17 m ²